



SILVER LAKE

Bio-Science Park Hanoi



Silverlake Bio-Science Park, also known as Biotec Park Hanoi, was officially established by the Prime Minister's Decision No. 1054/QĐ-TTg dated 29 September 2024, designating it as Vietnam's first high-tech biotechnology park.

Subsequently, the Hanoi People's Committee approved the 1 : 2000 zoning plan under Decision No. 2788/QĐ-UBND dated 5 June 2025, defining the detailed spatial framework for a 199-hectare site at Thuong Cat ward.

10 km from the Airport

1 km from the West Lake

1 km from Red River

199 ha

1 st Biotec Park in Vietnam

info@silverlake.bio

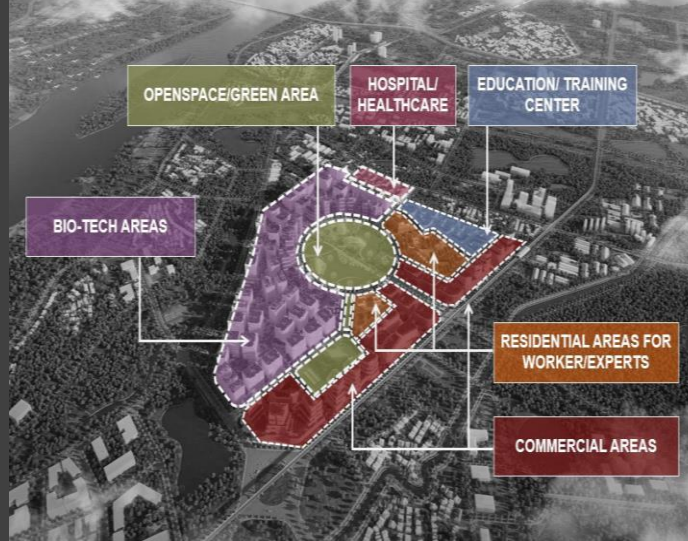



Pilotproject

Eco Industrial Park

Offices

Module size: ~4,000m²
Height: 25x4m (100m)

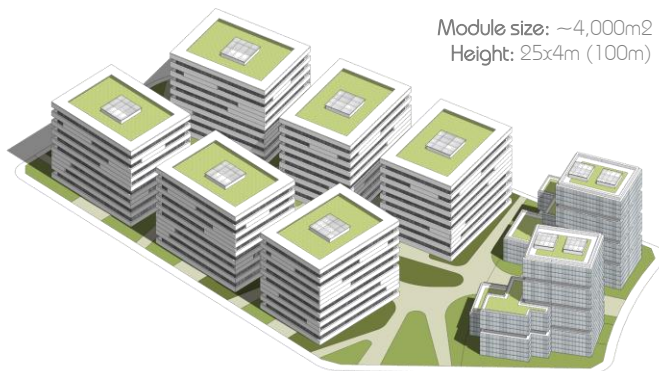

Maximum building density: 30% overall.
Height limits: 1–8 storeys, with key landmarks up to 25 storeys along the lake road.
Investor / developer: Pacific Land Vietnam JSC.
Total investment infrastructure: around VND 7,400 billion (≈ USD 290 million).
Core functions: biotechnology R&D, production, education, incubation, services, and residential amenities.

Urban design concept: centered on a north-south axis with the Silver Lake as a landscape core.

Strategic goal: to create Vietnam's first integrated biotechnology and life-science hub connecting research, industry, and urban life.

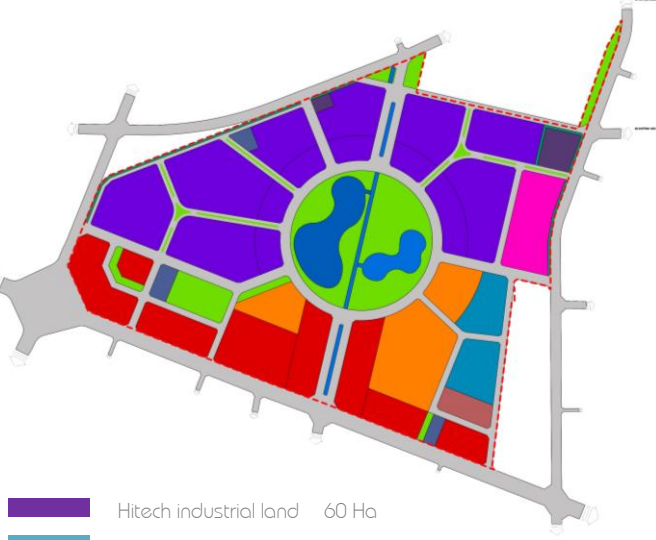

	Hitech industrial land	60 Ha
	R&D, Training Land	7.3 Ha
	Commercial	30 Ha
	Stay accomodation	16.6 Ha
	Medical center	6.5 Ha
	Education	2.0
	Green park	21 Ha
	Green buffer	0.45 Ha
	Infrastructure	2.6 Ha
	Water body	11.3 Ha

Lab/Institute

Module size: 60x80 (4800m²)
Height: 8x6m (48m)



Beta β

Site area: 104,015 m²
Function: Lab/Institute/Office
Levels: 8-20 Storey
Construction area: 43,190 m²
Density: 41.52%
GFA: 508,550 m²

Pi π

Site area: 64,590 m²
Function: Lab/Institute
Levels: 8-25 Storey
Construction area: 28,160 m²
Density: 43.6%
GFA: 404,800 m²

Delta Δ

Site area: 67,394 m²
Function: Lab/Institute
Levels: 8-35 Storey
Construction area: 28,528 m²
Density: 42.33%
GFA: 400,400 m²

Phi Φ

Site area: 95,236 m²
Function: Lab/Institute
Levels: 8-25 Storey
Construction area: 42,835 m²
Density: 44.524%
GFA: 690,075 m²

Gamma γ

Site area: 47,014 m²
Function: Facility
Levels: 8 Storey
Construction area: 20,000 m²
Density: 42.54%
GFA: 160,000 m²

Sigma σ

Site area: 77,318 m²
Function: Lab/Institute
Levels: 8 Storey
Construction area: 28,800 m²
Density: 37.24%
GFA: 250,400 m²

Alpha α

Site area: 85,774 m²
Function: Lab/Institute
Levels: 8-20 Storey
Construction area: 39,360 m²
Density: 45.88%
GFA: 494,400 m²

Omega Ω

